



Project Name:

Walton Ct (new intersection on the north side of US 78)

Project Location:

Located on the north side of US 78 between McGee Rd and Highpoint Rd (across from existing Walton Ct)

Project Sponsor:

Evermore Community Improvement District & Gwinnett County

Contact Information:

Brett Harrell; Executive Director Evermore CID

Need and Purpose Statement: *To improve mobility, enhance traffic and pedestrian safety and reduce the potential for traffic conflicts on US 78.*

Description of the Proposed Project: *The proposed project consists of approximately 600 feet of new intersection construction on the north side of US 78 and directly across from existing Walton Ct. The new intersection will tie into the re-alignment of Old Highway 78 (responsibility of the Brookwood Village developer). A total of three lanes is proposed where the proposed intersection intersect with US 78; one dedicated southbound thru lane, one dedicated right turn lane for turning movements onto westbound US 78 and one northbound thru lane. The need for a right-turn lane westbound on US 78 for northbound turning movements onto the new intersection will be evaluated during design. Three lanes will taper to two lanes where the LCI project limits and the developer funded re-alignment of Old Highway merge. The project is located in unincorporated Gwinnett County approximately .1 mile west of the Snellville city limits and within the Evermore Community Improvement District. Pedestrian safety will be provided via sidewalks on both sides of the new intersection with connectivity to the sidewalks being constructed as part of the US 78 Median Construction project. Evermore CID will assist Gwinnett County in the coordination of sidewalk connectivity between the Walton Ct project and the Brookwood Village Development*

The proposed project will decrease the number of vehicular conflict points on US 78. All future driveway access points from the proposed Brookwood development will be via the re-alignment of Old Highway 78 (by others). Traffic circulation will be improved with the ninety degree (90°) alignment of the proposed intersection project with Walton Ct. The existing signalized intersection at Walton Ct and US 78 will be upgraded to allow for pedestrian movements on the north side of US 78. Additional pedestrian safety elements will consist of pedestrian crossings, pedestrian refuge islands and a tree lined road.

Is the project located in a Non-attainment area?

Yes

No

ARC has a 13-county non-attainment area. All or part of the 21-county MPO Boundary is eligible for participation in the LCI program.

Does the project impact the ARC Model (see below criteria)?

Yes

No.

- Turn lanes that extend for more than 1/4 mile*
- Thru lanes that continue through an intersection*
- General capacity (additional lanes)*
- Reduction in capacity (taking away lanes)*
- New transit service including new park and ride lots*

Functional Classification (as determined by GDOT): *Re-alignment of local Road (Old Highway 78) & new intersection will be classified by Gwinnett County as an urban minor collector*

U. S. Route Number(s): N/A

State Route Number(s): N/A

Traffic (AADT):

Current Year: (2007) <50 (Old Highway 78)

Design Year: (2010) >500

The 2025 Design Hourly Volumes (1st diagram) and current/future AADT's on US 78 (2nd diagram) at the proposed intersection is shown as follows:

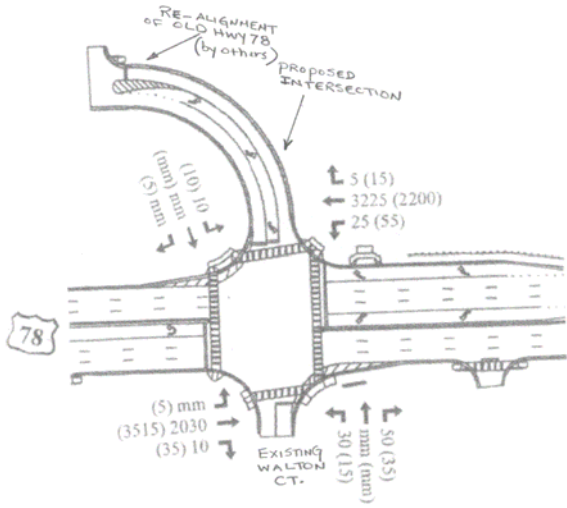

Legend:

- 100 2025 AM Peak Hour Turning Movement Volume
- (100) 2025 PM Peak Hour Turning Movement Volume

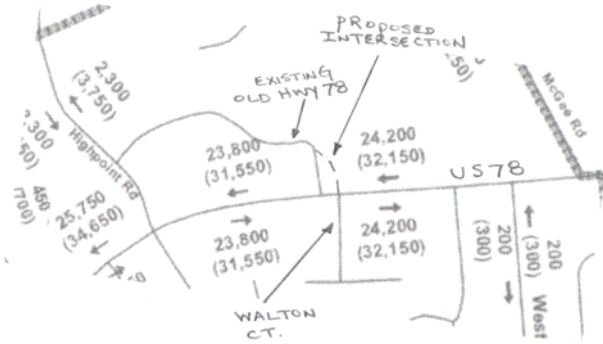

Legend

- LCI Study Area Boundary
- 1000 2005 Average Daily Traffic Volume
- {1000} 2025 Average Daily Traffic Volume

- Structures:
 - Bridges (*Describe*), *N.A.*
 - Retaining walls (*Describe alternates*) *N.A.*

- Major intersections and interchanges. *N.A.*

Design Exceptions or Variances to controlling criteria anticipated:

	<u>UNDETERMINED</u>	<u>YES</u>	<u>NO</u>
Horizontal Alignment:	x		
Roadway Width:			x
Shoulder Width:			x
Vertical Grades:			x
Cross Slopes:			x
Stopping Sight Distance:			x
Superelevation Rates:			
Horizontal Clearance:	x		
Speed Design:			x
Vertical Clearance:			x
Bridge Width: <i>N.A.</i>			
Bridge Structural Capacity: <i>N.A.</i>			

Design Variances:

1. Shoulder width on east side of proposed intersection; specifically at or near where the proposed intersection ties into US 78, may need to be decreased due to encroachment on adjoining tract of land.
2. Reduction in horizontal clearance (clear zone) for tree placement between sidewalk and back of curb

Project Responsibilities:

- Design – Gwinnett County DOT/Evermore CID (Consultant TBD) with GDOT review
- Right-of-Way Acquisition – Gwinnett County DOT/Evermore CID with GDOT review
- Relocation of Utilities – Gwinnett County /Evermore CID
- Letting to contract – Gwinnett County DOT/Evermore CID
- Supervision of construction – Gwinnett County DOT/Evermore CID
- Providing detours – none expected

Cost Estimates

	FEDERAL FUNDS:	MATCHING FUNDS:
PE	\$200,000	\$50,000
ROW	\$0	\$220,241
CST	\$233,600	\$58,400

Utilities: *Utility costs can not be paid for using federal transportation funds.*

Fiscal Years Proposed:

PE: FY08

ROW: FY2010

CST: FY2011

Proposed Project Schedule:

- Time to complete concept report: *2 Months.*
- Time to complete the environmental process: *6 Months.*
- Time to obtain design variance(s) or exception(s): *1 Month.*
- Time to complete preliminary engineering & right of way plans: *6 Months.*
- Time to complete construction plans: *3 Months.*
- Time to purchase right of way: *6 Months.*
- Time to complete final bid documents and execute project management agreements: *3 Months*
- List other major items that will affect the project schedule: *0 Months.*

Project Location Map

See attachment

Typical Cross Section:

See attachment plan view and cross section for new intersection

Project Support:

*Resolution of Support - City of Snellville and Gwinnett Board of Commissioners
(see attachment)*